



# DAEWOO

## PUMA 230MS PUMA 300MS

FIGURE 1

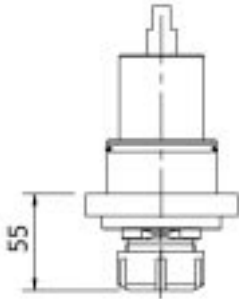

FIGURE 2

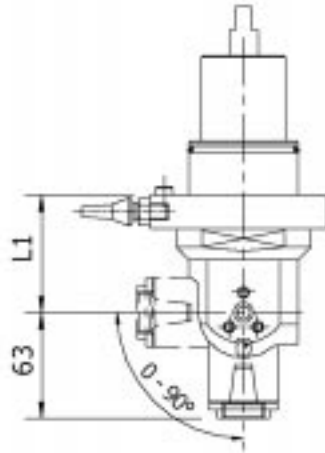

FIGURE 3

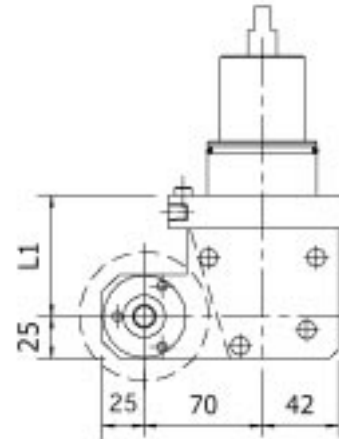

FIGURE 4

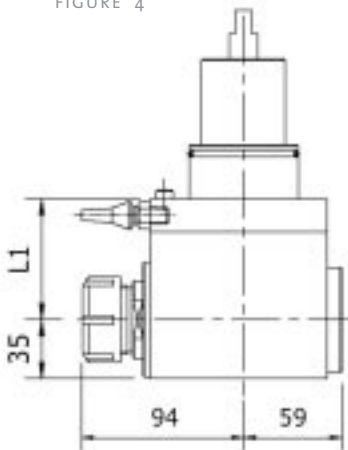

FIGURE 5

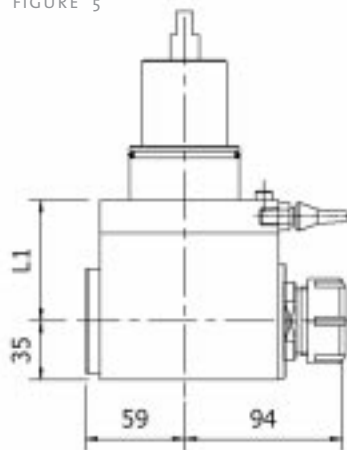
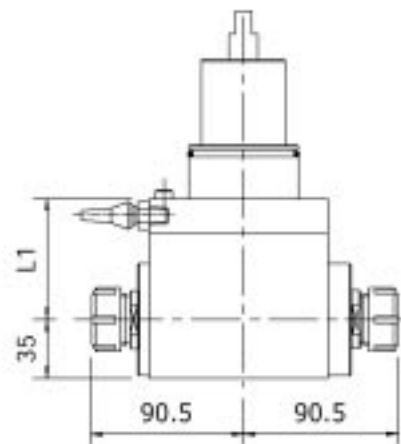

FIGURE 6



Order Code	MODEL	Tool Style	Spindle	Figure	MAX RPM	GearRatio	Nm	Option	L1
DW.000.230M	PUMA-230M	AXIAL	ER-32	1	4000	1:1 >	50	A, B, C	
DW.021.230M	PUMA-230M	ADJ ANGLE	ER-16	2	4000	1:1 <	18	D, B	40,5
DW.030.230M	PUMA-230M	SAW-MILL	Upon request	3	3000	1:1 <	25	B, C, D	65
DW.010.230M	PUMA-230M	RADIAL	ER-32	4	4000	1:1 <	50	A, B, C, D	60
DW.033.230M	PUMA-230M	RADIAL SUBSPINDLE	ER-32	5	4000	1:1 <	50	A, B, C, D	60
DW.008.230M	PUMA-230M	FACE/SUB-SPINDLE	ER-25/ER-25	6	4000	1:1 <	40	A, B, C	60
DW.000.300M	PUMA-300M	AXIAL	ER-32	1	4000	1:1 >	50	A, B, C	
DW.021.300M	PUMA-300M	ADJ ANGLE	ER-25	2	4000	1:1 <	30	D, B	63
DW.030.300M	PUMA-300M	SAW-MILL	Upon request	3	3000	1:1 <	25	B, C, D	72
DW.010.300M	PUMA-300M	RADIAL	ER-32	4	4000	1:1 <	50	A, B, C, D	72
DW.033.300M	PUMA-300M	RADIAL SUBSPINDLE	ER-32	5	4000	1:1 <	50	A, B, C, D	72
DW.008.300M	PUMA-300M	FACE/SUB-SPINDLE	ER-25/ER-25	6	4000	1:1 <	40	A, B, C	72

OTHER MODELS PLEASE ASK © MADAULA SA. SUBJECT TO CHANGE WITHOUT NOTICE

**OPTION CODE**

- A** OPTION - INTERNAL COOLANT
- B** OPTION - SPEED INCREASING
- C** OPTION - SPEED REDUCTION
- D** OPTION - RADIAL TOOL REVERSES FOR SUB-SPINDLE
- >** CW INPUT = CW OUTPUT
- <** CW INPUT = CCW OUTPUT

